

XAL

TIMO 80 FREE

053-033061PF

TECNI^{LUZ}

Quickinfo

GENERAL

white/black adaptor housing
1830 lm
Ceiling
Track
IP20

LED

4000 K
< 3 step MacAdam
CRI >80
L80 / 50000 h

OPTICAL

Flood
beam angle 38°

PHYSICAL

diameter 79 mm
tilt max 90°
rotation 355°
height 125 mm

ELECTRICAL

19 W
non DIM
EEI A++
94 lm/W

Light Distribution

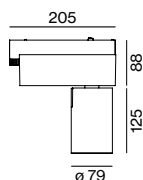
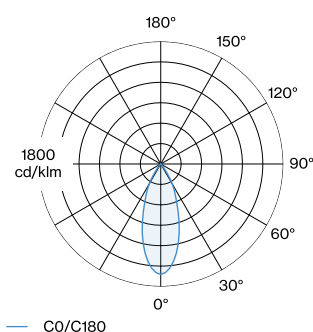

Cylindrical tracked spotlight in die-cast aluminium with low profile 3 phase universal adapter; optimized for installation in a Canyon or Minyon 50 channel, adapter and converter housing disappear in the channel; modern style in elegant design for discerning requirements; Control unit built into the spotlight housing; 355° rotatable and 90° tiltable; Spotlight surface white powder coated; adapter housing in black; passive cooling of the LEDs through improved heat sink geometry; with COB (Chip on Board) technology for maximum efficiency; no appearance of multiple shadows; light colour :4000 K; Binning: < 3 step MacAdam; CRI 80; at least 80% of luminous flux after 50,000 operating hours; including high quality aluminium reflector with spherical reflector; high gloss anodised; neutral colour reflection through absolute freedom from interference colour; for brilliant object staging; precise radiation characteristic with 36° beam; installed and exchanged without tools; special lenses (flood or sculpture optics) and honeycomb louvers are available as an accessory; 1 piece per spotlight can be used; Protection class IP20; PC I; incl. converter, non dimmable. luminous flux: 1830lm power: 19W efficiency: 94lm/W energy efficiency class: A++ dimensions: DxH: 79 x 125mm

OPTICAL ACCESSORIES

LENSES AND HONEYCOMB LOUVER

TYPE	L-H (MM)	ORDERCODE
linear prismatic lense	ø72-3	006-92207
honeycomb louver	ø72-3	006-93102

